

# Generation Comic Submission Layout

<http://paint.at/generation>

Creator: Katie Huang

Last Modified: 14/09/2004

## Page Layout

### Drawing frame (The dashed line)

panel borders should be drawn aligned to this line. No dialog text should be outside the frame

### Paper Edge

Edge of paper

### Bleed

Sometimes a panel has no border and extend to the edge of the paper. This is called bleed.

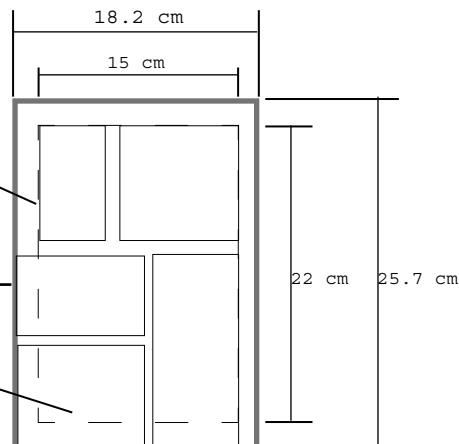

## Borders

### Border Line

a 0.5mm lineweight is recommended. If not so, it must be no less than 0.2mm

### Gaps

The standard page layout requires a 5mm gap between vertically adjacent panels and a 2mm gap between horizontally adjacent panels. This is done so readers will tend to read the horizontally adjacent panels before vertically adjacent panels. You do not have to strictly follow the rule. However a gap of at least 2mm is advised between each panel so the page will not appear cluttered.

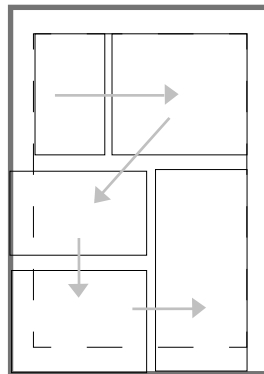

## Left/ Right

Please specify if you have designed your page to be starting from Left/Right. Make sure important parts are not within the blue region. If you are not sure which side your page is, don't draw anything important on the grey area too.



## Flow/Direction

Panel Arrangement:

Left → Right

Top → Bottom

Word arrangement:

Horizontal Left to Right

