

A-pillar trim

To remove

1. Remove the screw cover from the A-pillar trim. Use [82 93 474 removal tool](#). **butter knife**
2. Remove the fixing screws from the A-pillar trim. Do not screw completely out as there are expanders on the screws which can be lost.
3. Grip the bottom edge of the A-pillar trim and carefully pull straight out.

To fit

1. Position the A-pillar trim. Be careful not to damage the collision curtain.
2. Fit the A-pillar trim fixing screws.
Tightening torque 5 Nm (4 lbf ft)
3. Fit the screw cover to the A-pillar trim.

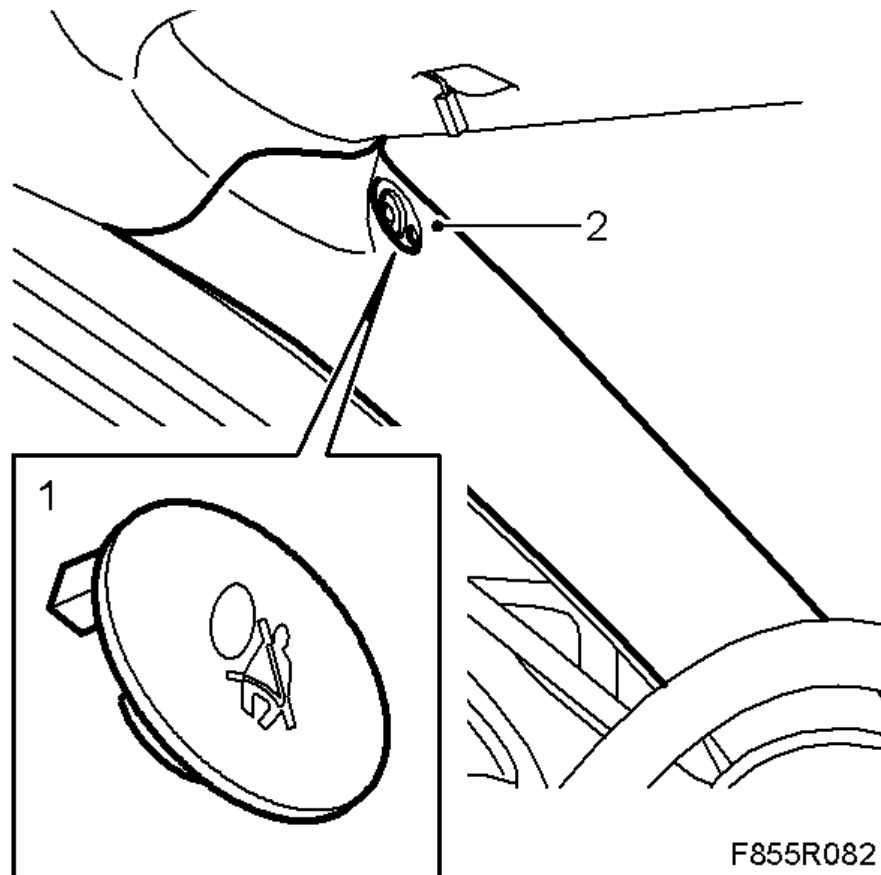

F855R082